

# Specification

## ST5005E-3

## 3WellSteamTable



- ◆ Easy to clean.
- ◆ Stainless Steel Construction.
- ◆ Uses Edgeless Water pan.
- ◆ ½” polyethylene cutting board.
- ◆ Adjustable stainless-steel legs.
- ◆ Thermostatic heat controls and indicator lights.
- ◆ 8” deep open well design fits full size spillage pans.
- ◆ Individually controlled 500W tubular heating elements



**Intertek**  
CONFORMS TO NSF/ANSI 4

**Note: Dimensions and Specification are subject to change without notice.**

Cozo c's 8"deep open well steam table features individual bays(uses edge less water pan) , each with independent temperature controls perfect for maintaining hot foods. Adjustable unit height, constructed of stainless steel with four stainless-steel legs and stainless-steel under shelf, 1/2" thick polyethylene cutting board for workspace. Individually controlled 500wtubular heating elements in each bay assuring proper holding temperatures

# Dimensions and Specifications

## ST5005E-3



Front View

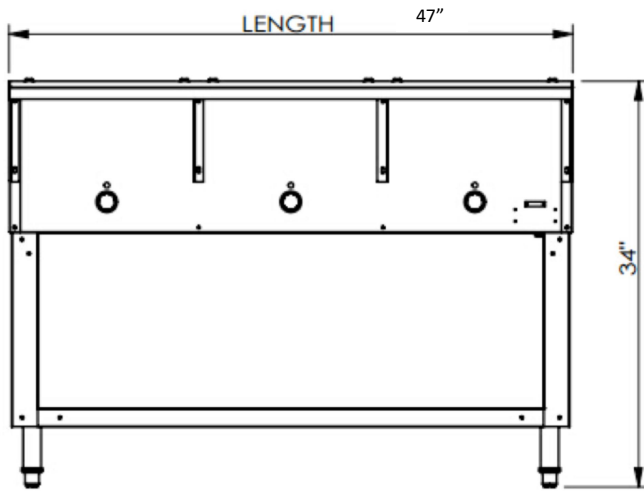

Side View

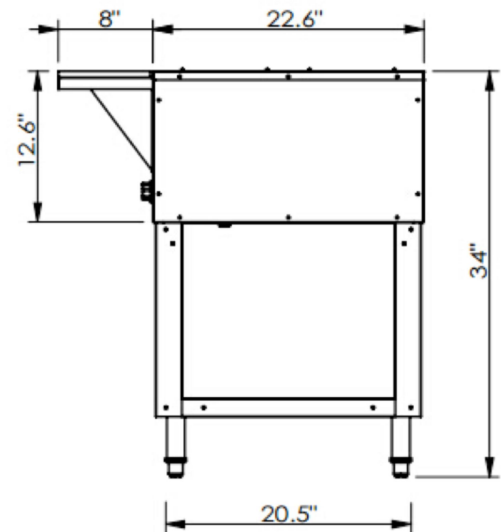

Pan	Use edgeless water pan
Options	None
Electrical	1 20 Volts
Power	1500 Watts
Net weight	112 lbs.
Gross shipping weight	116 lbs.
Class	1 00
Dimensions	47" W X 30.6" D X 34" H
Package	50 " W X 26" D X 19" H
Warranty	1Year Manufactures limited Warranty